

Discover your Stateroom*

Elegant and flexible staterooms and suites, decorated by French interior designers, all with sea views.

Accommodation

OWNER'S SUITE

45 sq.m + 40 sq.m. private terrace* with hot tub and sliding bay windows
484 sq.ft + 430 sq.ft. private terrace* with hot tub and sliding bay windows

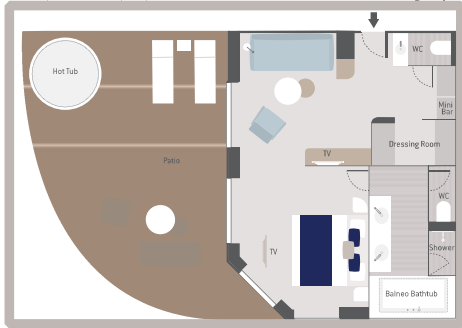

(*30 sq.m. private terrace aboard *Le Lapérouse* and *Le Champlain* / 323 sq.ft. private terrace aboard *Le Lapérouse* and *Le Champlain*)

GRAND DELUXE SUITES

45 sq.m + 30 sq.m. private terrace and sliding bay windows
484 sq.ft + 323 sq.ft. private terrace and sliding bay windows
(Deck 5: 40 sq.m. private terrace with hot tub* and sliding bay windows)

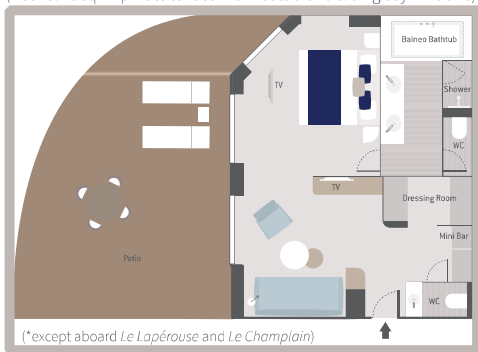

(*except aboard *Le Lapérouse* and *Le Champlain*)

4 PRIVILEGE SUITES

32 sq.m + 8 sq.m. private balcony with sliding bay window
344 sq.ft + 86 sq.ft. private balcony with sliding bay window



18 PRESTIGE SUITES

38 sq.m + 8 sq.m. private balcony with sliding bay window
409 sq.ft + 86 sq.ft. private balcony with sliding bay window

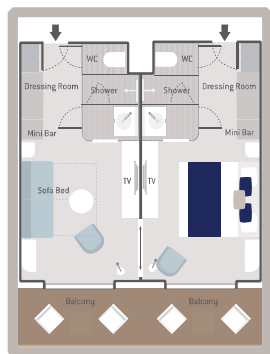

66 PRESTIGE STATEROOMS

19 sq.m + 4 sq.m. private balcony with sliding bay window
204 sq.ft + 43 sq.ft. private balcony with sliding bay window



5 DELUXE SUITES

27.5 sq.m + 6 sq.m. private balcony with sliding bay window
291 sq.ft + 65 sq.ft. private balcony with sliding bay window



13 DELUXE STATEROOMS

19 sq.m + 4 sq.m. private balcony with French window
204 sq.ft + 43 sq.ft. private balcony with French window

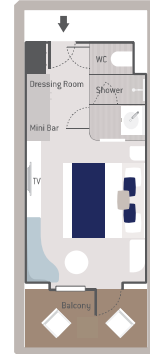

Amenities

- Individually controlled air conditioning
- Stateroom layout: king-size bed or twin beds, interconnecting staterooms available (children welcome)
- Mini Bar
- Flat screen satellite TV
- Video on demand
- iPod™ docking stations
- Desk with stationery
- Safe
- Hermès® French bath products
- Dressing table, bath robes, hair dryer
- Direct line telephone
- 110V American (two flat pins) / 220V European (round sockets with two round pins)
- 24hr room service
- Complimentary and unlimited Wi-Fi Internet access

Public areas

RECEPTION AREA

140 sq.m. / 1507 sq.ft - Reception (Concierge) Desk, Excursion Desk, Sales Office and Ship's Administrative Services. 50 sq.m. / 538 sq.ft - Boutique (Shop).

MAIN LOUNGE

200 sq.m. / 2153 sq.ft which can accommodate all of our guests to share convivial moments and to host activities organised during the day or evening.

BLUE EYE LOUNGE

Multi-sensory underwater lounge which can accommodate 40 guests.

RESTAURANTS

• Grill Restaurant

Capacity: 70
Buffet & Grill

• Panoramic Restaurant

Capacity : all guests
Buffet & table service
Restaurant opens onto the outside deck

RECREATION / RELAXATION

• Hydraulic Platform

- Easier boarding
- Easier Zodiac® embarkation and disembarkation
- Easier access to the sea for practising various water sports such as kayaking or paddle boarding.

• Pool Deck

- Pool with a panoramic view, equipped with a counter-current swimming system
- Sun deck
- Outdoor bar and lounge

• Theatre

- Capacity: 188
- Main show room for lectures, briefings and live entertainment on selected evenings
 - State-of-the-art audio and video technology



* Non-contractual plans: *Le Bellot* and *Le Jacques-Cartier* are under construction.