

P&O CRUISES

LIKE NO PLACE ON EARTH

PACIFIC ADVENTURE®  
& PACIFIC ENCOUNTER®  
*Accommodation Guide*



WE'RE HERE  
TO HELP!

Please talk to your travel agent,  
visit [www.pocruises.com.au](http://www.pocruises.com.au)  
or call us on 1300 159 454 if  
you have any questions on your  
cruise accommodation booking.

# ACCOMMODATION GUIDE

## *Overview*

### CONTENTS

ROOM TYPES .....	03
ROOM AMENITIES SUMMARY .....	03
INTERIOR .....	04
OCEANVIEW & OCEANVIEW OBSTRUCTED .....	05
BALCONY .....	06
MINI-SUITE WITH BALCONY .....	08
5-BERTH FAMILY ROOM .....	10
8-BERTH FAMILY ROOM .....	11
SUITES .....	12
INTERCONNECTING ROOMS .....	14
WHEELCHAIR ACCESSIBLE .....	15
PACIFIC ADVENTURE® DECK PLAN .....	16
PACIFIC ENCOUNTER® DECK PLAN .....	17
ADDITIONAL ACCOMMODATION FACTS .....	18
ROOM SERVICE .....	18

## CHOOSE YOUR ROOM

### INTERIOR

Perfect for budget conscious Cruiselings, these cosy rooms come in a range of bedding configurations.

### OCEANVIEW

Wake up to a sparkling new view everyday!

### BALCONY

Enjoy the crisp ocean air and your own outdoor relaxation space.

### 5-BERTH FAMILY ROOM

Offering a full length light-filled window\*\* or balcony, our 5-berth family rooms are perfect for families or friends who want a bit of extra space.

### 8-BERTH FAMILY ROOM

A spacious hideaway for the family with all the delights of a hotel.

### MINI-SUITE

Enjoy all the comforts of home. All Mini Suites include a spacious living area and a full balcony.

### SUITE

Get the special treatment. Enjoy a balcony, extra room, priority spa and dinner reservations, plus so much more.

### INTERCONNECTING ROOMS

The perfect combination of space, proximity and privacy. Enjoy neighbouring rooms with internal doors, suited perfect for families and friends.

### WHEELCHAIR ACCESSIBLE ROOMS

Wheelchair accessible rooms are subject to availability. All requests must be made at time of booking.

## YOUR HOME AWAY FROM HOME

FEATURE	INTERIOR	OCEANVIEW	BALCONY	INTERCONNECTING	MINI SUITE	SUITE	5-BERTH FAMILY ROOMS	8-BERTH FAMILY ROOM
En-suite bathroom	✓	✓	✓	✓	✓	✓	✓	✓
Wardrobe & dressing area	✓	✓	✓	✓	✓	✓	✓	✓
Walk-in wardrobe	-	-	-	✓	✓	✓	✓	✓
Fridge	✓	✓	✓	✓	✓	✓	✓	✓
In-room safe	✓	✓	✓	✓	✓	✓	✓	✓
Room serviced twice daily	-	-	-	-	-	✓	✓	✓
In-room dining*	✓	✓	✓	✓	✓	✓	✓	✓
Fresh towels daily (upon request)	✓	✓	✓	✓	✓	✓	✓	✓
Floor-to-ceiling windows**	-	-	✓	-	✓	✓	✓	✓
Balcony with outdoor furniture <sup>^</sup>	-	-	✓	✓	✓	✓	✓	✓
Spacious living area	-	-	-	-	✓	✓	✓	✓
Priority embarkation, disembarkation and tender disembarkation	-	-	-	-	✓	✓	✓	✓
Complimentary use of bathrobes	-	-	-	-	✓	✓	✓	✓
Free laundry	-	-	-	-	-	✓	✓	✓
Priority dining, spa & shore tour reservations	-	-	-	-	-	✓	✓	✓
Coffee machine	-	-	-	-	-	✓	✓	✓
Pillow concierge	✓	✓	✓	✓	✓	✓	✓	✓
TV & Telephone*	✓	✓	✓	✓	✓	✓	✓	✓
Air conditioning with personal controls	✓	✓	✓	✓	✓	✓	✓	✓
Priority service line/desk	-	-	-	-	-	✓	✓	✓
Priority bookings for Future Cruise	-	-	-	-	-	✓	✓	✓
Complimentary bottled water x 2	-	-	-	-	-	✓	✓	✓
Privacy curtain	-	-	-	-	-	✓	-	-
Spa Baths	-	-	-	-	-	✓	-	✓
Complimentary shoe shine service	✓	✓	✓	✓	✓	✓	✓	✓
Welcome message to children from TC and Skipper	✓	✓	✓	✓	✓	✓	✓	✓

\* Charges may apply

\*\* 5-Berth Family Rooms - Floor-to-ceiling windows available only on Pacific Encounter.

<sup>^</sup> 5-Berth Family Rooms - Balcony with outdoor furniture available only on Pacific Encounter.

# INTERIOR



## THE DETAILS

### FEATURES

Twin beds that convert to a queen*	✓
En-suite bathroom	✓
Wardrobe and dressing area	✓
Fridge	✓
In-room safe	✓
Fresh towels each day (on request)	✓
Pillow concierge (choice of up to 3 different types of pillows)	✓

### WHAT YOU'LL LOVE MOST

- ★ Budget friendly
- ★ Flexible room capacity choice
- ★ En-suite bathroom

### CAPACITY (SLEEPS UP TO 4)

<b>TWIN ROOMS</b>	Feature Twin beds which can convert into a queen bed*
<b>TRIPLE ROOMS</b>	Feature twin beds + one single upper bunk
<b>QUAD ROOMS</b>	Feature two lower single beds + two upper

### MEASUREMENTS

<b>TOTAL ROOM SIZE</b>	14.7 sq metres
<b>CABIN DOOR WIDTH</b>	57 cm

### DECK / ROOM

II:	DECK 11, 10	ID:	Deck 11, 10, 9
IA:	DECK 11, 10	IE:	Deck 12, 11, 10, 9, 8
IB:	Deck 12, 11, 10, 9	IF:	Deck 14, 12, 8, 5
IC:	Deck 14, 12, 8, 5		

• Third or fourth berth available

\* Some interior rooms have twins bed that DO NOT convert to queen.

## ROOM CONFIGURATIONS

### INTERIOR – QUEEN



### INTERIOR – TRIPLE



### INTERIOR – TWIN



### INTERIOR – QUAD



Room images are for illustration purposes only. Actual room layout, configurations and design may vary. Bed frame size descriptions are provided as a guide only and may not conform with standard Australian dimensions. Please check at time of booking.

## A COSY HIDEAWAY *to rest and recharge*

Our Interior rooms are perfect for the budget conscious. Available in a range of bedding configurations including twin, queen, triple and quad share, they suit families, friends and couples. With comfortable furnishings and soft beds, you'll love having a cosy place to return to after a day of cruise fun.

# OCEANVIEW



## THE DETAILS

### FEATURES

Two twin beds that convert to a queen*	✓
Window or porthole**	✓
En-suite bathroom	✓
Wardrobe & dressing area	✓
Fridge	✓
In-room safe	✓
Fresh towels each day (on request)	✓
Pillow concierge (choice of up to 3 different types of pillows)	✓

### WHAT YOU'LL LOVE MOST

- ★ Window or porthole\*\*
- ★ En-suite bathroom
- ★ Flexible room capacity choice

### CAPACITY\*\* (SLEEPS UP TO 4)

<b>TWIN ROOMS</b>	Feature twin beds which can convert into a queen bed*
<b>TRIPLE ROOMS</b>	Feature twin beds + one single upper bunk
<b>QUAD ROOMS</b>	Feature two lower single beds + two upper

### MEASUREMENTS

<b>TOTAL ROOM SIZE</b>	14.7 sq metres
<b>CABIN DOOR WIDTH</b>	57 cm

### DECK / ROOM

OI: DECK 8 Obstructed view	OV: DECK 8 Obstructed view
OC: Deck 5	OV: DECK 8 Obstructed view
OF: Deck 5	OV: DECK 8 Obstructed view
OP: Deck 12 Porthole	

- Third or fourth berth available
- ◆ Porthole

\* Some Oceanview rooms have twins bed that DO NOT convert to queen.  
 \*\* Some Oceanview rooms have windows obstructed by tender boats or ship structures (obstructed view cabins are on Deck 8)

## ROOM CONFIGURATIONS

### OCEANVIEW – QUEEN



### OCEANVIEW – TRIPLE

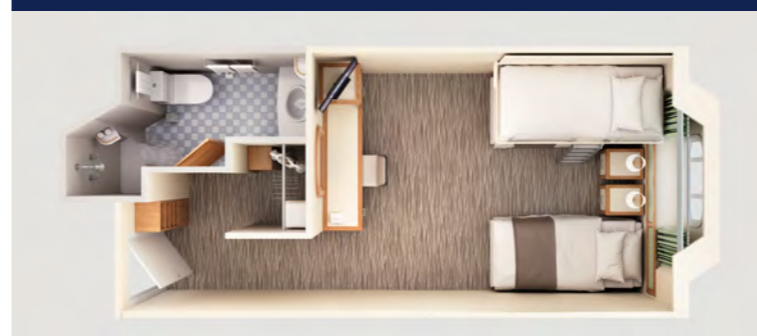

### OCEANVIEW – TWIN



### OCEANVIEW – QUAD



Room images are for illustration purposes only. Actual room layout, configurations and design may vary. Bed frame size descriptions are provided as a guide only and may not conform with standard Australian dimensions. Please check at time of booking.

**WAKE UP TO A**  
*new view everyday!*

Wake up to a new view\*\* every day in our comfortable Oceanview rooms. Featuring a window or porthole and equipped with everything you need, Oceanview rooms are available in a range of bedding configurations. They are perfect for couples, families, friends or just about anyone.

# BALCONY



**FRESH AIR**  
*and never-ending views*

Slide your balcony door wide open and breathe in the crisp ocean air. With all the comforts of a hotel, you'll feel completely relaxed lounging on your private balcony, feet up, soaking up the sunshine with unlimited ocean views. Order in some delicious cocktails or curl up with a book for the ultimate holiday vibe.

## ROOM CONFIGURATIONS

### BALCONY – QUEEN



### BALCONY – QUAD (POP-UP BUNKS)

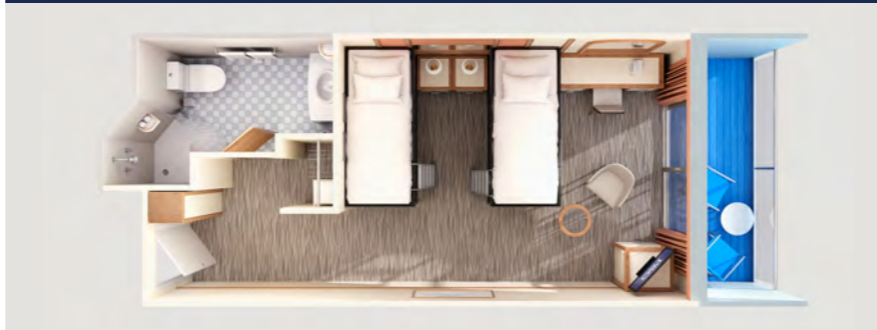

## THE DETAILS

### FEATURES

Two twin beds that convert to a queen*	✓
En-suite bathroom	✓
Wardrobe and dressing area	✓
Fridge	✓
In-room safe	✓
Fresh towels each day (on request)	✓
Floor-to-ceiling windows	✓
Balcony with outdoor furniture	✓
Pillow concierge (choice of up to 3 different types of pillows)	✓

### WHAT YOU'LL LOVE MOST

- ★ Private balcony
- ★ Never-ending views
- ★ Flexible room capacity choice

### CAPACITY (SLEEPS UP TO 4)

**TWIN ROOMS** Feature twin beds that can be converted to a queen bed\*

**TRIPLE ROOMS** Feature twin beds with one upper single bunk.

**QUAD ROOMS**

**Varied layouts:**

- » Feature pop-up bunks, consisting of two single beds that can be transformed into two sets of single bunk beds (one upper and one lower). Lower bunks can also be joined to make one lower queen bed with 2 upper singles.
- » Feature one single bed, one single sofa bed + two upper (bunk) single beds

### MEASUREMENTS

**TOTAL ROOM SIZE** 15.6 sq metres

**CABIN DOOR WIDTH** 57 cm

**BALCONY SIZE** 4.3 sq metres  
Balcony sizes may differ dependant on deck position

### DECK / ROOM

<b>B1:</b> Deck 10	<b>BC:</b> Deck 14, 12
<b>B2:</b> Deck 10, 9, 8	<b>BD:</b> Deck 11, 10
<b>BA:</b> Deck 11	<b>BE:</b> Deck 12, 11, 10
<b>BB:</b> Deck 12, 11	<b>BF:</b> Deck 14, 12, 8

● Third or fourth berth available

\* Some Quad Balcony rooms have twins bed that DO NOT convert to queen



Room images are for illustration purposes only. Actual room layout, configurations and design may vary. Bed frame size descriptions are provided as a guide only and may not conform with standard Australian dimensions. Please check at time of booking.

# BALCONY (CONT)



## ROOM CONFIGURATIONS

BALCONY – QUAD



BALCONY – TRIPLE



BALCONY – TWIN



Room images are for illustration purposes only. Actual room layout, configurations and design may vary. Bed frame size descriptions are provided as a guide only and may not conform with standard Australian dimensions. Please check at time of booking.

# MINI SUITE



## YOUR OWN PRIVATE *relaxation space*

Our Mini Suites are light and airy, with floor to ceiling windows, a full balcony and a comfortable, stylish living area. You'll have plenty of room to unpack, stretch out and unwind in front of stunning ocean views.

## ROOM CONFIGURATIONS

### MINI SUITE – QUAD (QUEEN + SINGLE SOFA + 1 UPPER)



### MINI SUITE – QUAD (TWIN + SINGLE SOFA + 1 UPPER)



## THE DETAILS

### FEATURES

Private balcony and spacious living area	✓
Floor to ceiling windows	✓
Bathroom with shower over bath	✓
Pillow concierge (choice of up to 3 different types of pillows)	✓
Complimentary use of bathrobes	✓
Priority embarkation, disembarkation and tendering	✓
Welcome aboard letter from Hotel Director	✓
Premium bathroom amenities	✓
Premium bed linen and towels	✓

### WHAT YOU'LL LOVE MOST

- ★ Private balcony
- ★ Pillow concierge
- ★ Complimentary fluffy robe
- ★ Byron Beach Club (M1 grade only)

### CAPACITY (SLEEPS UP TO 4)

#### TWIN ROOMS

MD - All mini suite, queen beds can be converted to twins in PV/PI EXCEPT 9732 and 9733 rooms. These are twin bed only, wheelchair accessible rooms.

#### TRIPLE AND QUAD ROOMS

Feature twin beds that convert to a queen plus a single sofa bed. Quads also include an upper single.

### MEASUREMENTS

<b>TOTAL ROOM SIZE</b>	21.1 sq metres
<b>CABIN DOOR WIDTH</b>	57 cm
<b>BALCONY SIZE</b>	4.3 sq metres

### DECK / ROOM

MA• DECK 9	ME• DECK 8
MB• DECK 9	M1• DECK 9
MD• DECK 9	

- Third berth available
  - Third or fourth berth available
- Only MD & ME 4 berths. Others are 3 berths.

\* Access to Byron Beach Club facilities and benefits is only available to guests in Suites and M1 grade mini suites. Please check eligibility when booking.



Room images are for illustration purposes only. Actual room layout, configurations and design may vary. Bed frame size descriptions are provided as a guide only and may not conform with standard Australian dimensions. Please check at time of booking.



# MINI SUITE (CONT)



## ROOM CONFIGURATIONS

MINI SUITE – TRIPLE (QUEEN + SINGLE SOFA)



MINI SUITE – TRIPLE (TWIN + SINGLE SOFA)



\* Access to Byron Beach Club facilities and benefits is only available to guests in Suites and M1 grade mini suites. Please check eligibility when booking.

Room images are for illustration purposes only. Actual room layout, configurations and design may vary. Bed frame size descriptions are provided as a guide only and may not conform with standard Australian dimensions. Please check at time of booking.

# 5-BERTH FAMILY ROOM



YOUR 'SUITE' Spot

Our 5-berth family rooms are perfect for families or friends who want a bit of extra space and some of the 'sweet' suite benefits.

On Pacific Adventure, these rooms are centrally located and perfect for watching the world pass by.\*

On Pacific Encounter, 5-berth family rooms have a balcony. Guests enjoy all the sweet 'suite' benefits as well as access to the Byron Beach Club.\*

## ROOM CONFIGURATIONS

### 5-BERTH SUITE – QUEEN + SOFA BUNK + FOLD-OUT BED



### 5-BERTH SUITE – TWIN + SOFA BUNK + FOLD-OUT BED



## THE DETAILS

### FEATURES

Private balcony and spacious living area	✓
Floor to ceiling windows <sup>A</sup>	✓
Bathroom with bath and shower	✓
Walk-in wardrobe with dressing area, desk with chair	✓
Safety deposit box	✓
Fridge	✓
Air-conditioning with personal controls	✓
Pillow concierge (choice of up to 3 different types of pillows)	✓
Invitation to 'Meet the Officers' cocktail party (on cruises over 5 nights)	✓
Complimentary bottled water x 2 and laundry service	✓
Coffee machine	✓
Unique cruise card	✓
Welcome letter from Hotel Director	✓
Priority ship embarkation, disembarkation and tender disembarkation	✓
Priority dining and spa reservations	✓
Priority bookings for Future Cruise	✓
Priority bookings for shore tours and Shorex Manager contact	✓
Maitre'd contact for preferred dining	✓
Private Dining (Breakfast only) - Angelos	✓
Snacks/Canape selection by choice (available from Day 2)	✓
Welcome glass of sparkling wine on arrival	✓
Fresh fruit replenishment by preference	✓
Premium bathroom amenities	✓
Complimentary use of bathrobes	✓
Turndown service	✓
Optional complimentary breakfast served in suite	✓

### WHAT YOU'LL LOVE MOST

- ★ Family friendly
- ★ Turndown service
- ★ Byron Beach Club (Pacific Encounter only)

### CAPACITY (SLEEPS UP TO 5)

<b>TWIN ROOMS</b>	Feature twin beds that can be converted into a queen
<b>TRIPLE AND QUAD ROOMS</b>	Feature twin beds that can be converted into a queen. Plus single sofa bunk and a single fold-out bed.
<b>5-BERTH ROOMS</b>	S56315 - can sleep 5, however when a wheelchair is present only 4 guests can fit comfortably. Only available on Pacific Adventure.

### MEASUREMENTS

<b>TOTAL ROOM SIZE</b>	31.7 sq metres
<b>CABIN DOOR WIDTH</b>	87 cm

### DECK / ROOM

<b>S58</b> DECK 6 (Pacific Adventure)	<b>PBS</b> DECK 10 (Pacific Encounter)
---------------------------------------	--

**S** Fifth berth available

\* Access to Byron Beach Club facilities and benefits is only available to guests in Suites and M1 Grade Mini suites. It is not available for guests in 5-berth family rooms on Pacific Adventure. Please check eligibility when booking.

<sup>A</sup> Floor-to-ceiling windows only available on Pacific Encounter

Room images are for illustration purposes only. Actual room layout, configurations and design may vary. Bed frame size descriptions are provided as a guide only and may not conform with standard Australian dimensions. Please check at time of booking.

# 8-BERTH FAMILY ROOM



**FAMILY**  
*friendly*

Families will love the extra space in our 2 bedroom family suites. With your own private balcony, extra living space, 2 bedrooms, 2 bathrooms and sweet 'suite' benefits...  
happy holidays!

## ROOM CONFIGURATIONS

8-BERTH FAMILY ROOM – QUEEN + 2 SINGLES + 2 UPPERS + DUO SOFA BED



## THE DETAILS

### FEATURES

Private balcony and spacious living area	✓
Floor to ceiling windows	✓
Bathroom with bath and shower	✓
Walk-in wardrobe with dressing area, desk with chair	✓
Safety deposit box	✓
Fridge	✓
Air-conditioning with personal controls	✓
Pillow concierge (choice of up to 3 different types of pillows)	✓
Invitation to 'Meet the Officers' cocktail party (on cruises over 5 nights)	✓
Complimentary bottled water x 2 and laundry service	✓
Coffee machine	✓
Unique cruise card	✓
Welcome letter from Hotel Director	✓
Priority ship embarkation, disembarkation and tender disembarkation	✓
Priority dining and spa reservations	✓
Priority bookings for Future Cruise	✓
Priority bookings for shore tours and Shorex Manager contact	✓
Maitre'd contact for preferred dining	✓
Private Dining (Breakfast only) - Angelos	✓
Snacks/Canape selection by choice (available from Day 2)	✓
Welcome glass of sparkling wine on arrival	✓
Fresh fruit replenishment by preference	✓
Premium bathroom amenities	✓
Complimentary use of bathrobes	✓
Turndown service	✓
Optional complimentary breakfast served in suite	✓

### WHAT YOU'LL LOVE MOST

- ★ Family or group friendly
- ★ Large private balcony
- ★ Spacious living area
- ★ Two bathrooms and one bathtub
- ★ Byron Beach Club

### CAPACITY (SLEEPS UP TO 8)

#### 8-BERTH FAMILY ROOM

- » One bedroom with two lower beds that DO NOT convert to a queen + two uppers
- » Duo Sofa bed is designed to sleep two guests

### MEASUREMENTS

<b>TOTAL ROOM SIZE</b>	31.2 sq metres
<b>CABIN DOOR WIDTH</b>	57 cm
<b>BALCONY SIZE</b>	8.5 sq metres

### DECK / ROOM

S8π DECK 9

π Connecting rooms with private balcony; will accommodate 6-8 persons

*Room images are for illustration purposes only. Actual room layout, configurations and design may vary. Bed frame size descriptions are provided as a guide only and may not conform with standard Australian dimensions. Please check at time of booking.*

# SUITE



## LIVE THE "Suite" life

Nothing's sweeter than some extra special treatment. Our large, light-filled suites are designed with ultimate comfort and style in mind. Stretch out in a spacious separate sitting area, sip coffee or cocktails on your balcony, enjoy priority shore tour reservations, dining and spa reservations, free laundry and loads more.

## ROOM CONFIGURATIONS

### SUITE QUAD – QUEEN + SOFA DOUBLE



### SUITE QUAD – TWIN + SOFA SINGLE + FOLD-OUT BED



## THE DETAILS

### FEATURES

Private balcony and spacious living area	✓
Floor to ceiling windows	✓
Bathroom with bath and shower	✓
Walk-in wardrobe with dressing area, desk with chair	✓
Safety deposit box	✓
Fridge	✓
Air-conditioning with personal controls	✓
Pillow concierge (choice of up to 3 different types of pillows)	✓
Invitation to 'Meet the Officers' cocktail party (on cruises over 5 nights)	✓
Complimentary bottled water x 2 and laundry service	✓
Coffee machine	✓
Unique cruise card	✓
Welcome letter from Hotel Director	✓
Priority ship embarkation, disembarkation and tender disembarkation	✓
Priority dining and spa reservations	✓
Priority bookings for Future Cruise	✓
Priority bookings for shore tours and Shorex Manager contact	✓
Maitre'd contact for preferred dining	✓
Private Dining (Breakfast only) - Angelos	✓
Snacks/Canape selection by choice (available from Day 2)	✓
Welcome glass of sparkling wine on arrival	✓
Fresh fruit replenishment by preference	✓
Premium bathroom amenities	✓
Complimentary use of bathrobes	✓
Turndown service	✓
Optional complimentary breakfast served in suite	✓

Room images are for illustration purposes only. Actual room layout, configurations and design may vary. Bed frame size descriptions are provided as a guide only and may not conform with standard Australian dimensions. Please check at time of booking.

### WHAT YOU'LL LOVE MOST

- ★ Byron Beach Club
- ★ Private balcony
- ★ Priority dining and spa reservations
- ★ Coffee machine

### CAPACITY (SLEEPS UP TO 4)

<b>TWIN ROOMS</b>	Queen/ Twin beds + double sofa bed*
	» Queen/ Twin beds + Sofa (Single) + Upper (Single)
	» Queen/ Twin beds + double sofa bed*
<b>TRIPLE AND QUAD ROOMS</b>	» Queen/ Twin beds + single sofa bed**
	» Queen/ Twin & Sofa (Single) + Fold-out Single^

### MEASUREMENTS

<b>TOTAL ROOM SIZE</b>	Varies from 28.25 sq metres to 60 sq metres
<b>CABIN DOOR WIDTH</b>	57 cm
<b>BALCONY SIZE</b>	Ranges from 10.9 sq metres to 16 sq metres
<b>SV CATEGORY (PACIFIC ADVENTURE ONLY)</b>	
<b>CABIN DOOR WIDTH</b>	67 cm

### DECK / ROOM

GS	DECK 11	OS	DECK 10
PA	DECK 11	SP	DECK 10, 9, 8
PB	DECK 11, 10	SV	DECK 10, 9, & 8

- Third berth available
- Third or fourth berth available

\* Double sofa bed only available in GS + OS (PV/ PI) + Deck 15 Suites (PV only)

\*\* Configuration is only applicable to Deck 10 Mid and Aft Suites & 11749 (PI & PV)

^ Configuration is only possible for Deck 8 & Deck 9 Aft Suites (8732, 8733, 9737 & 9738, PI & PV). Also, fold-out bed is only possible if the upperbunk is not in use

# SUITE (CONT)



## ROOM CONFIGURATIONS

SUITE QUAD – QUEEN + SOFA SINGLE + 1 UPPER



SUITE QUAD – QUEEN + SOFA SINGLE + FOLD-OUT BED



SUITE QUAD – TWIN + SOFA DOUBLE



SUITE QUAD – TWIN + SOFA SINGLE + FOLD-OUT BED



SUITE QUAD – TWIN + SOFA SINGLE + 1 UPPER



SUITE TRIPLE – TWIN + SOFA SINGLE



Room images are for illustration purposes only. Actual room layout, configurations and design may vary. Bed frame size descriptions are provided as a guide only and may not conform with standard Australian dimensions. Please check at time of booking.

# INTERCONNECTING



**KEEP YOUR  
loved ones close**

The ideal combination of space, proximity and privacy. Enjoy neighbouring rooms, with a private, interconnecting door between each. Perfect for ensuring your privacy, the added space of a second room with amenities, plus the security of knowing your loved ones are close by. Well suited for families and friends.

## ROOM CONFIGURATIONS

### QUEEN INTERCONNECTING



### TWIN INTERCONNECTING

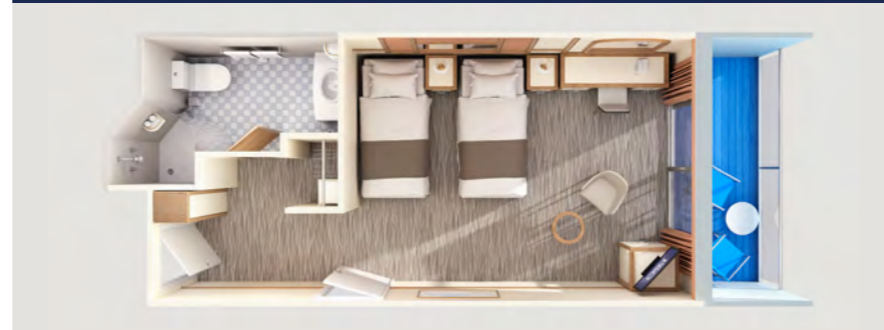

\*Interconnecting rooms are available across Interior, Oceanview and Balcony room types

## THE DETAILS

### FEATURES

Internal door connecting with room next door	✓
Private ensuite bathroom with shower	✓
Fridge	✓
In-room safe and telephone	✓
Telephone	✓
Wardrobe	✓
Desk with chair	✓
Queen bed or twin bedding	✓
Pillow concierge (choice of up to 3 different types of pillows)	✓

### WHAT YOU'LL LOVE MOST

- ★ Adjoining rooms with private internal door
- ★ Flexible bedding configurations
- ★ Available across interior, balcony & oceanview rooms

### CAPACITY

<b>TWIN ROOMS</b>	Feature twin beds which can convert into a queen bed
<b>TRIPLE ROOMS</b>	Feature twin beds + one single upper bunk
<b>QUAD ROOMS</b>	<p><b>Configuration varies between:</b></p> <ul style="list-style-type: none"> <li>» Interior rooms feature two lower single beds + two upper (bunk) single beds</li> <li>» Balcony rooms feature two lower single beds + two upper (bunk) single beds.</li> <li>» Some bunks in Balcony rooms only, can also be joined to make a lower queen with 2 upper singles</li> </ul>
<b>CAPACITY</b>	Maximum capacity varies between 2 and 4 guests per room. Please check with P&O for specific room information.

### MEASUREMENTS

<b>INTERIOR &amp; OCEANVIEW ROOM SIZE</b>	14.7 sq metres
<b>BALCONY SIZE</b>	15.6 sq metres
<b>DOOR WIDTH</b>	57cm
<b>BALCONY SIZE</b>	4.3 sq metres Balcony sizes may differ dependant on deck position

### DECK / ROOM

● DECK 8	● DECK 10
● DECK 10	● DECK 11
● DECK 10	● DECK 15

- Third berth available
- Third or fourth berth available
- ★ Some rooms will have obstructed views  
Some quad balcony rooms have twins bed that DO NOT convert to queen.

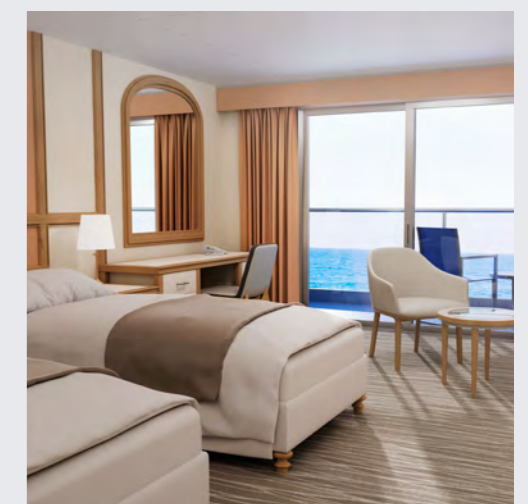

Room images are for illustration purposes only. Actual room layout, configurations and design may vary. Bed frame size descriptions are provided as a guide only and may not conform with standard Australian dimensions. Please check at time of booking.

# WHEELCHAIR ACCESSIBLE



## WHEELCHAIR Accessible

P&O Cruises makes every effort to accommodate guests with disabilities. We have a limited number of wheelchair accessible rooms, subject to availability at the time of booking. If you have any special requirements, please let us know at the time of booking.

## ROOM CONFIGURATIONS

### WHEELCHAIR ACCESSIBLE – QUEEN



## THE DETAILS

### FEATURES

Room inclusions as per those listed previously for Balcony rooms and lower categories. Wheelchair Accessible rooms also include:

Wider doorways onto the room and bathroom	✓
More spacious room to enable a wheelchair to be used in the room	✓
Spacious bathroom with shower only (no bath or spa)	✓
Extra handrails in the bathroom	✓
Shower seat	✓
No steps into bathroom or shower	✓
Balcony Wheelchair rooms will be provided with a ramp to access the balcony.	✓
Pillow concierge (choice of up to 3 different types of pillows)	✓

### WHAT YOU'LL LOVE MOST

- ★ Wider doorways
- ★ More spacious room
- ★ Extra handrails and/or fold down shower seats
- ★ No steps

### CAPACITY (SLEEPS UP TO 4)

<b>TWIN ROOMS</b>	Feature twin beds which can be converted into a queen bed aside from 9732 and 9733 on both ships, which have two single beds which are fixed against the walls and do not convert.
<b>TRIPLE ROOMS</b>	Feature 2 berths and 1 upper. This configuration is only available in IE 8716 and 8717 rooms. All other Wheelchair Accessible Rooms are double occupancy.
<b>5-BERTH ROOMS</b>	S56315 - can sleep 5, however when a wheelchair is present only 4 guests can fit comfortably. Only available on Pacific Adventure.

### MEASUREMENTS

<b>TOTAL ROOM SIZE</b>	Rooms size varies between 20.02 sq m and 35.6 sq m
<b>CABIN DOOR WIDTH</b>	Door width ranges between 86 and 88cm
<b>BATHROOM DOOR WIDTH</b>	83 cm

### DECK / ROOM

S5§ 6315 (Pacific Adventure only)	OW* 8301, 8302, 8303 & 8304
MD* 9732 & 9733	IB* 10248, 10252, 10312
B2* 10301, 10302, 10303 & 10304	IC* 12248, 12252, 12312, 14248 & 14252
BB* 11301, 11302, 11303 & 11304	IE• 8716 & 8717
BC* 12301, 12302, 12303 & 12304	

- \* Two berth only
- Third berth available
- § Fifth berth available



Room images are for illustration purposes only. Actual room layout, configurations and design may vary. Bed frame size descriptions are provided as a guide only and may not conform with standard Australian dimensions. Please check at time of booking.



# Pacific ADVENTURE®

2,600 GUESTS, LOWER BERTHS | 12 GUEST DECKS  
290 M IN LENGTH | 108,865 GROSS TONNAGE

## ROOM GRADING

### SUITE

- GS+** DECK 11  
Access to Byron Beach Club
- OS:** DECK 15, 11  
Access to Byron Beach Club
- PA:** DECK 11, 10  
Access to Byron Beach Club
- PB:** DECK 10  
Access to Byron Beach Club
- SP:** DECK 15  
Access to Byron Beach Club
- SV:** DECK 10, 9, 8  
Access to Byron Beach Club
- SB m** DECK 9  
2-Bedroom 8-Berth Family Room.  
Access to Byron Beach Club.
- SS<sup>x</sup>** DECK 6  
Window Suite, 5 berth,  
no balcony, no access to  
Byron Beach Club

### MINI-SUITE

- M1:** DECK 9  
Access to Byron Beach Club
- MA:** DECK 9
- MB:** DECK 9
- MD:** DECK 9
- ME:** DECK 8

### BALCONY

- BL:** DECK 10
- B2:** DECK 10, 9, 8
- BA:** DECK 11
- BB:** DECK 12, 11
- BC:** DECK 14, 12
- BD:** DECK 11, 10
- BE:** DECK 12, 11, 10
- BF:** DECK 14, 12, 8

### OCEANVIEW

- OI:** DECK 8  
Interconnecting  
Obstructed view
- OC:** DECK 5
- OF:** DECK 5
- OP:** DECK 12  
Porthole
- OV:** DECK 8  
Obstructed view
- OW:** DECK 8  
Obstructed view
- OY:** DECK 15, 8  
Obstructed view

### INTERIOR

- II:** DECK 11, 10
- IA:** DECK 11, 10
- IB:** DECK 12, 11, 10, 9
- IC:** DECK 14, 12, 8, 5
- ID:** DECK 11, 10, 9
- IE:** DECK 12, 11, 10, 9, 8
- IF:** DECK 14, 12, 8, 5

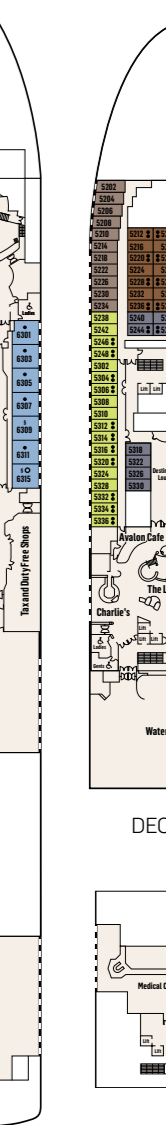
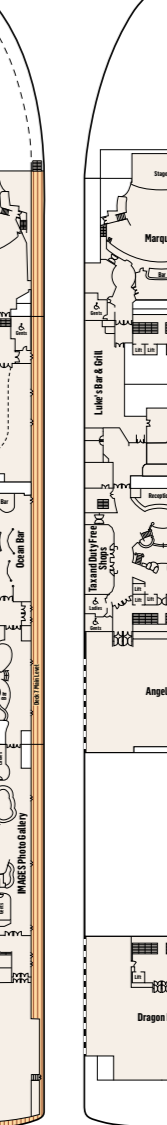
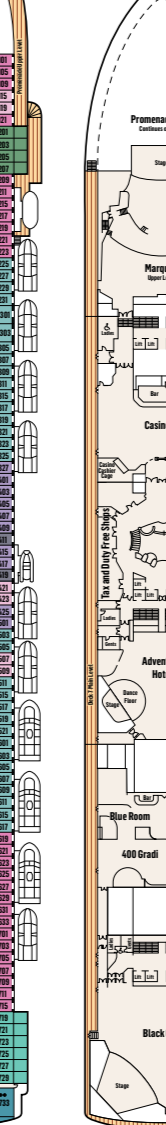
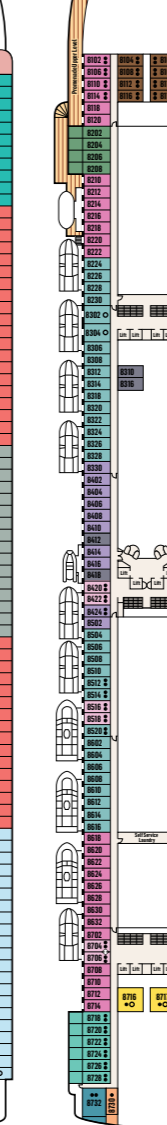
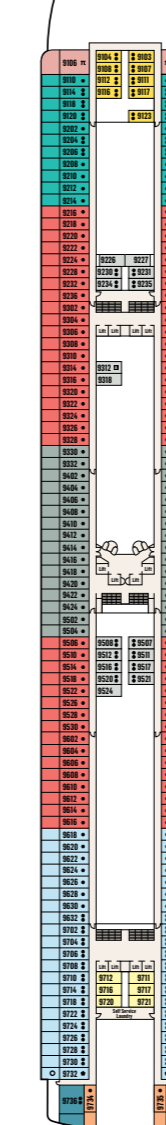
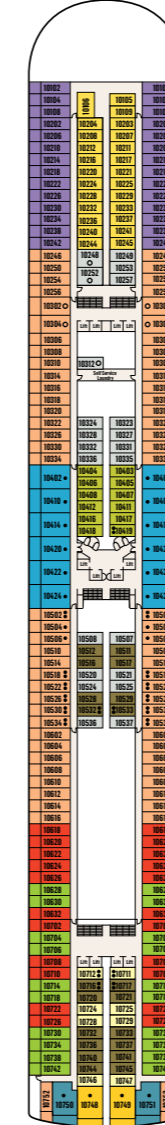
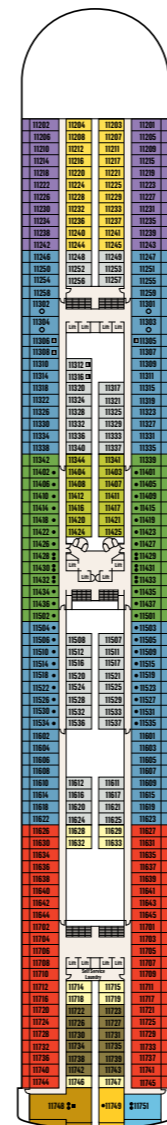
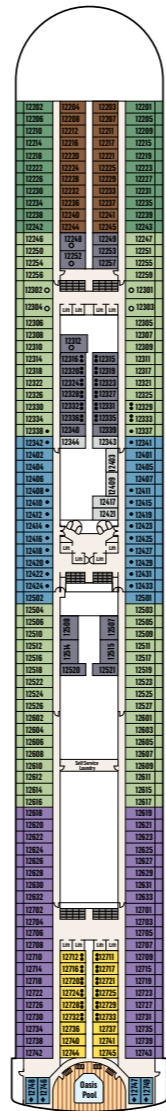
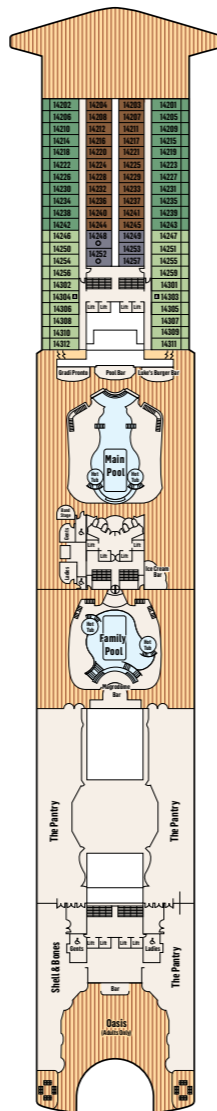
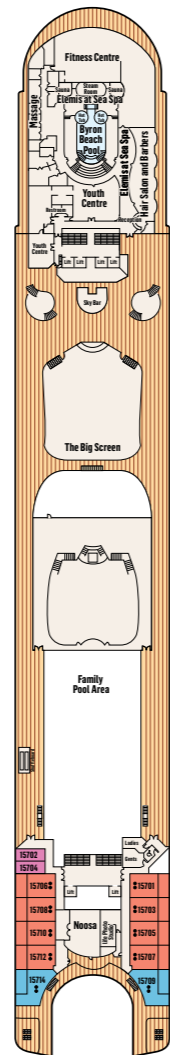
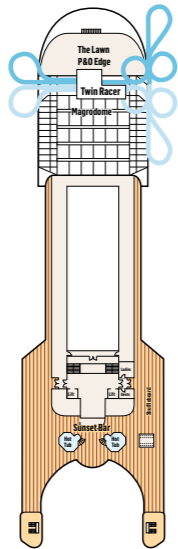
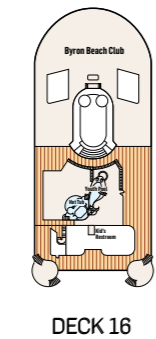

- Third berth available
- Third or fourth berth available
- § Fifth berth available
- π Connecting rooms with private balcony; will accommodate 6-8 persons
- ◆ Porthole
- 🛏 Twin beds only
- X No access to Byron Beach Club

- Wheelchair-accessible room  
Includes wider doorways (to accommodate a wheelchair), no thresholds into the bathroom and more handrails around the bathroom. Please check at time of booking.
- Fixed queen-size bed, cannot be converted to twin beds
- ▲ Ambulatory Accessible room  
Accessible features may include grab bars and/or fold down shower seats. These rooms are not wheel chair accessible.

Note: Cots are available in selected rooms and are not available in any interior & oceanview quad rooms. Contact P&O Cruises for more information. Deck plans are for illustration purposes only. They are not to scale and are subject to change. Bedding configuration of three- and four-berth rooms may vary, and it may not be possible to have queen bedding when the third and fourth beds (upper bunks) are in use. Please check with your travel agent or our Customer Service team at the time of booking for bedding configuration.

Please note the configuration and room grading of Pacific Adventure may change.

- DECK 17/18
- DECK 16
- DECK 14
- DECK 11
- DECK 9
- DECK 7
- DECK 5

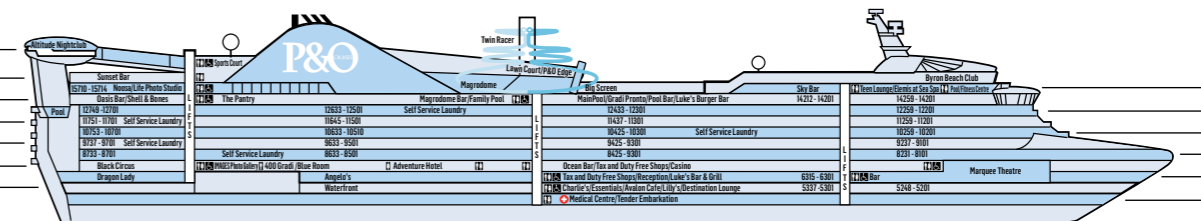

- DECK 15
- DECK 12
- DECK 10
- DECK 8
- DECK 6
- DECK 4





# Pacific ENCOUNTER®

2,600 GUESTS, LOWER BERTHS | 12 GUEST DECKS  
290 M IN LENGTH | 108,865 GROSS TONNAGE

## ROOM GRADING

### SUITE

- GS:** DECK 11  
Access to Byron Beach Club
- OS:** DECK 11  
Access to Byron Beach Club
- PA:** DECK 11, 10  
Access to Byron Beach Club
- PB1:** DECK 10  
5-Berth Family Room  
Access to Byron Beach Club
- SV:** DECK 10, 9, 8  
Access to Byron Beach Club
- S8n:** DECK 9  
2-Bedroom 8-Berth Family Room.  
Access to Byron Beach Club.

### MINI-SUITE

- M1:** DECK 9  
Access to Byron Beach Club
- MA:** DECK 9
- MB:** DECK 9
- MD:** DECK 9
- ME:** DECK 8

### BALCONY

- BI:** DECK 10
- B2:** DECK 10, 9, 8
- BA:** DECK 11
- BB:** DECK 12, 11
- BC:** DECK 14, 12
- BD:** DECK 11, 10
- BE:** DECK 12, 11, 10
- BF:** DECK 14, 12, 8

### OCEANVIEW

- OI:** DECK 8  
Obstructed view
- OC:** DECK 5
- OF:** DECK 5
- OP:** DECK 12  
Porthole
- OV:** DECK 8  
Obstructed view
- OW:** DECK 8  
Obstructed view
- OY:** DECK 8  
Obstructed view

### INTERIOR

- II:** DECK 11, 10
- IA:** DECK 11, 10
- IB:** DECK 12, 11, 10, 9
- IC:** DECK 14, 12, 8, 5
- ID:** DECK 11, 10, 9
- IE:** DECK 12, 11, 10, 9, 8
- IF:** DECK 14, 12, 8, 5

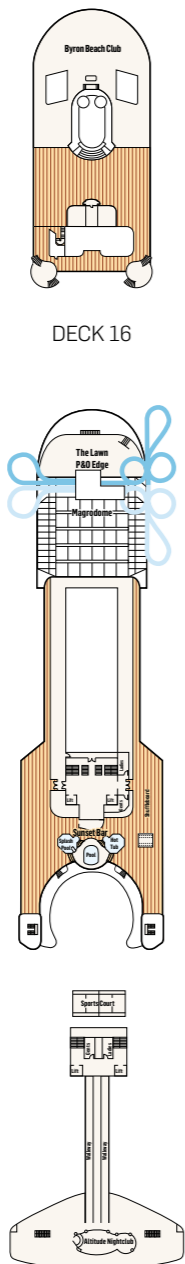

DECK 17/18

DECK 15

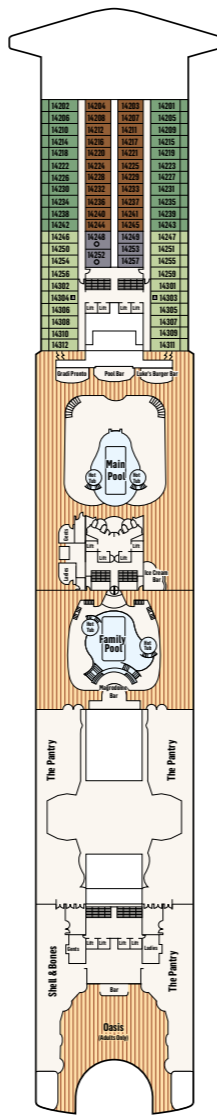

DECK 14

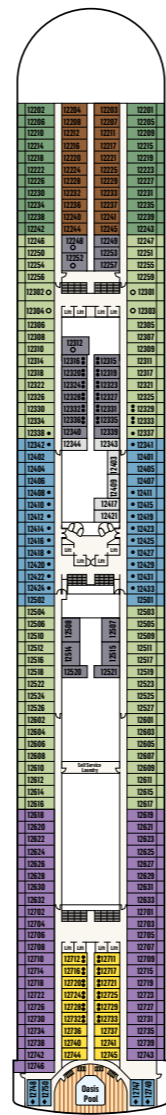

DECK 12

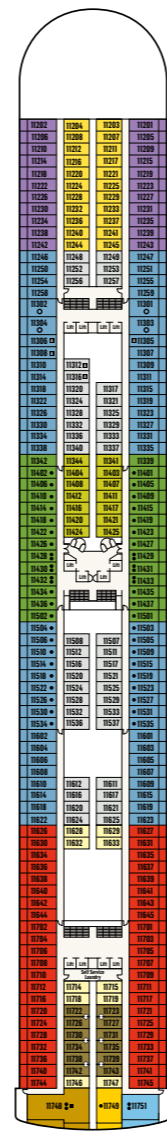

DECK 11

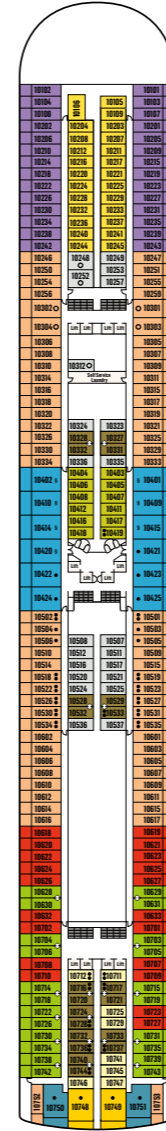

DECK 10

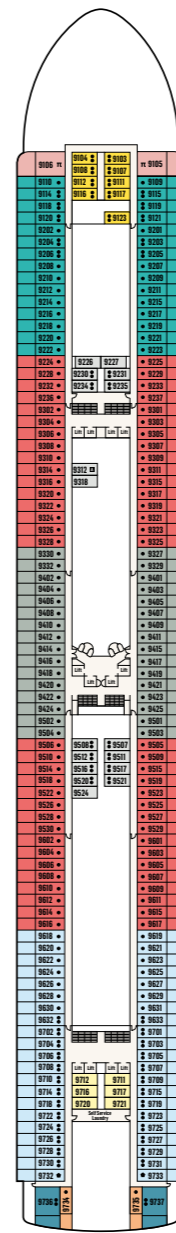

DECK 9

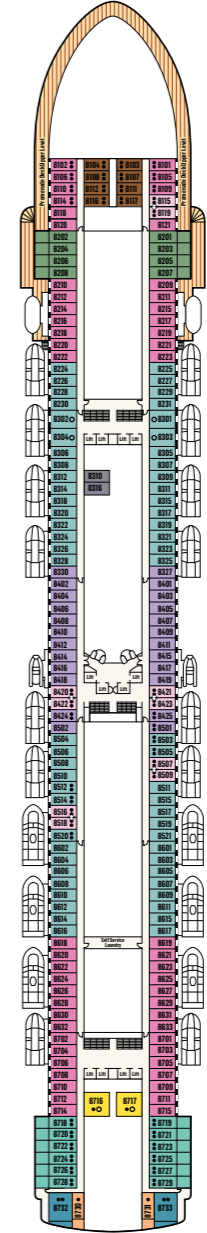

DECK 8

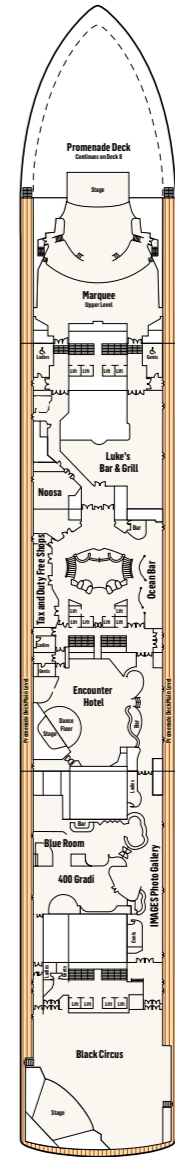

DECK 7

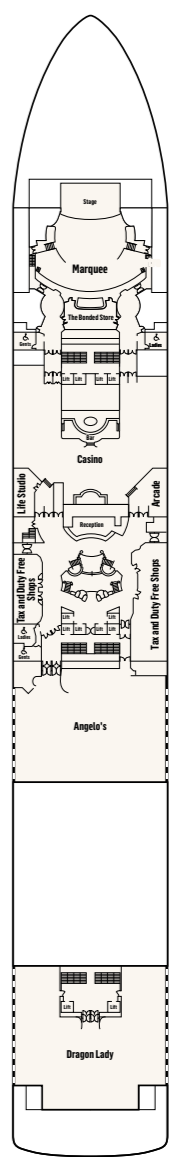

DECK 6

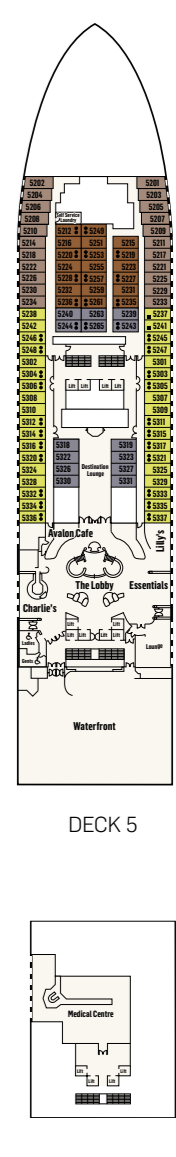

DECK 5

- Third berth available
- Third or fourth berth available
- S** Fifth berth available
- ⌘** Connecting rooms with private balcony; will accommodate 6-8 persons
- ◆** Porthole
- 🛏** Twin beds only
- ↔** Interconnecting rooms
- Wheelchair-accessible room  
Includes wider doorways (to accommodate a wheelchair), no thresholds into the bathroom and more handrails around the bathroom. Please check at time of booking.
- Fixed queen-size bed, cannot be converted to twin beds
- A** Ambulatory Accessible room  
Accessible features may include grab bars and/or fold down shower seats. These rooms are not wheel chair accessible.

Note: Cots are available in selected rooms and are not available in any interior & oceanview quad rooms. Contact P&O Cruises for more information. Deck plans are for illustration purposes only. They are not to scale and are subject to change. Bedding configuration of three- and four-berth rooms may vary, and it may not be possible to have queen bedding when the third and fourth beds (upper bunks) are in use. Please check with your travel agent or our Customer Service team at the time of booking for bedding configuration.

Please note Public spaces, configuration and room grading of Pacific Encounter may change.  
Twin Racer Waterslides will be installed on Pacific Encounter in March 2023.

- DECK 17/18
- DECK 16
- DECK 14
- DECK 11
- DECK 9
- DECK 7
- DECK 5

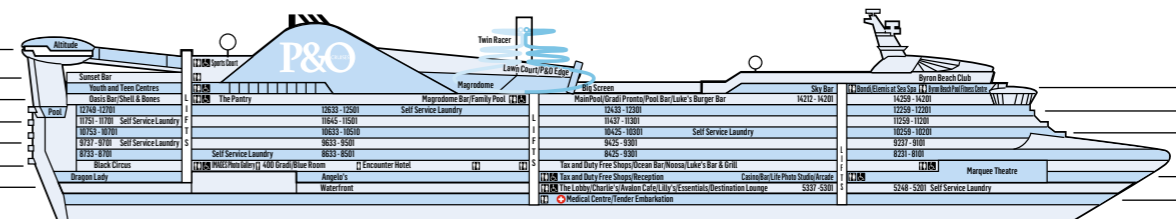

- DECK 15
- DECK 12
- DECK 10
- DECK 8
- DECK 6
- DECK 4

FORWARD

AFT

# ROOM SERVICE



## ADDITIONAL ACCOMMODATION FACTS

- ◆ Bedding configuration of three and four-berth rooms may vary, and it may not be possible to have queen bedding when the third and fourth beds (upper bunks) are in use.
- ◆ Some quad interior, oceanview and balcony rooms have twins bed that DO NOT convert to queen. For example: Some quad rooms may contain 2 single beds and 2 upper bunks. If this is the case, the 2 single beds cannot be converted to a queen bed due to the position of the ladders for the upper bunks.
- ◆ Some triple rooms may contain 2 single beds and 1 upper bunk. If this is the case, the 2 single beds cannot be converted to a queen.
- ◆ Some quad rooms have a sofa bed that converts to a double bed, while others have a single sofa bed with 1 upper.
- ◆ Fixed queen-size beds, cannot be converted to twin beds.
- ◆ Some Oceanview rooms have windows obstructed by lifeboats or ship structures. Specifically OV, OW & OY categories on Deck 8.
- ◆ Byron Beach Club entry is limited to guests in select Suite and M1 mini suite rooms only.
- ◆ If guests have limited mobility and require a shower that is not over a bath tub, it is recommended that they book a Limited Mobility Room or Wheelchair Accessible Room. They can also book a Balcony, Oceanview or Interior room as these have a shower only and are easier to step in and out of.
- ◆ Wheelchair accessible rooms are more spacious and have additional features to enable a wheelchair to be used in the room. See page 15 for details.
- ◆ Limited Accessibility rooms and Ambulatory Accessible rooms have additional features in the bathrooms, such as handrails and shower seats, but have standard size doorways, room dimensions and are not wheelchair accessible. These rooms are tailored for guests that have limited mobility and are not confined to a wheelchair.
- ◆ The following rooms on Pacific Encounter & Pacific Adventure are Limited Mobility
  - » **BB** – 11305, 11306, 11308
  - » **BC** – 14303, 14304
  - » **IB** – 11312, 11316, 9312
 All are 2 berths (twin or queen)
- ◆ Cots are available in selected rooms and are not available in any Quad Interior & Quad Oceanview rooms. Cots can also only be added to rooms with a twin bed configuration. Please make sure that this configuration is requested at time of booking.



## FOR A LITTLE EXTRA

### ROOM SERVICE

We are offering an extensive food and beverage in-room menu, including a breakfast selection, for your enjoyment (Charges apply). If you are staying in a suite there is a complimentary and full breakfast service in a designated private dining area, in addition to a complimentary in-room-breakfast, fresh fruit selection and in-room-snacks and bites menu.

### IRONING

Forgot to iron your shirt? No worries! Our super express service can have your shirt back to you in 30 mins. \$5 per shirt.

### LAUNDRY

We offer laundry service so you can spend more time enjoying your holiday. There is a laundry bag and price list in your wardrobe. Just fill in the form and we'll come and pick it up so you don't have to miss a moment of cruise fun.

## INCLUDED IN YOUR FARE INC

### DAILY SERVICE

Relax – you're on holiday. No need to make the bed or clean the bathroom. We'll do it for you, twice daily! We know that fresh towels are one of life's little luxuries. Let us know if you want extra towels replaced with fresh ones. Service only available to Suites, 5-berth and 8-berth family rooms.

### SAY OMMM

Namaste. If you prefer to do your exercises in the comfort of your room, alone on deck, or even ashore on the beach – let us know and we'll have a yoga mat delivered to your room.

