

## SYMBOL LEGEND

- ♣ Restrooms
- E Elevator
- 🚪 Launderette
- OV Obstructed Views
- Quad with Pullman
- ★ ★ Quad with Sofabed
- || Connecting Staterooms
- ♿ Wheelchair Accessible
- ▲ Triple with Pullman
- ★ Triple with Sofabed
- ◇ 3rd guest occupancy available upon request

## STATEROOM COLOR LEGEND

- |    |    |     |     |     |    |    |    |
|----|----|-----|-----|-----|----|----|----|
| OS | VS | PH1 | PH2 | PH3 | A1 | A2 | A3 |
| B1 | B2 | C1  | C2  | D   | S  | F  | G  |

## SHIPS' SPECIFICATIONS

Year Built: *Regatta* 1998; *Nautica* 2000 | Re-Inspiration Dates: *Regatta* 2019; *Nautica* 2022  
 Gross Tonnage: 30,277 | Length: 593.7 feet | Beam: 83.5 feet | Cruising Speed: 18 knots | Guest Decks: 9  
 Guest Capacity (Double Occupancy): 656 | Staff Size: 400 | Guest-to-Staff Ratio: 1.64 to 1  
 Nationality of Officers: European | Country of Registry: Marshall Islands

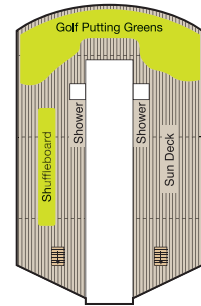

### DECK 11

- Golf Putting Greens
- Shuffleboard
- Sun Deck

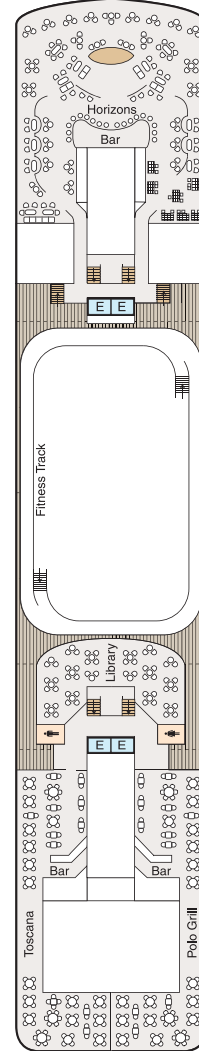

### DECK 10

- Toscana
- Polo Grill
- Library
- Fitness Track
- Horizons

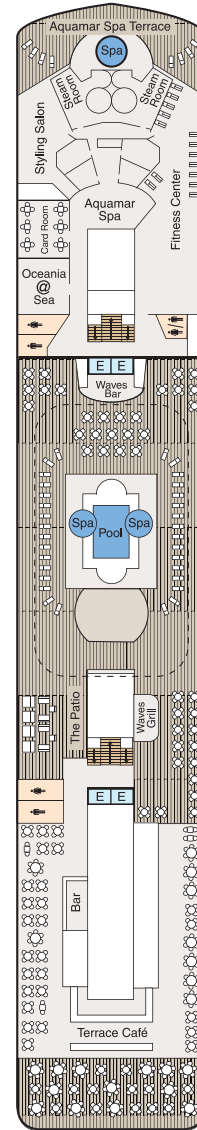

### DECK 9

- Terrace Café
- Waves Grill
- Waves Bar
- Pool Deck
- Oceania@Sea
- Aquamar Spa + Vitality Center
- Fitness Center
- Salon

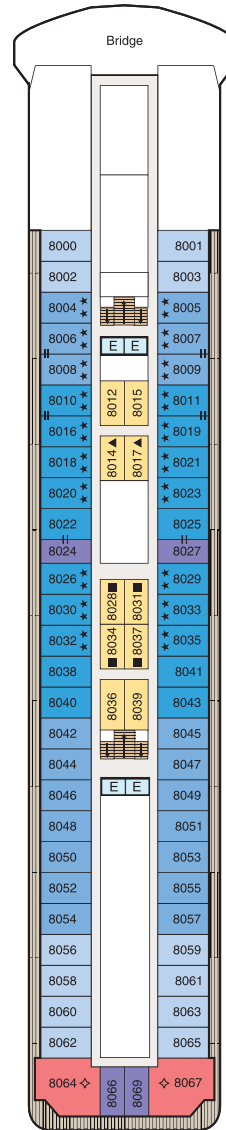

### DECK 8

- Bridge
- Staterooms

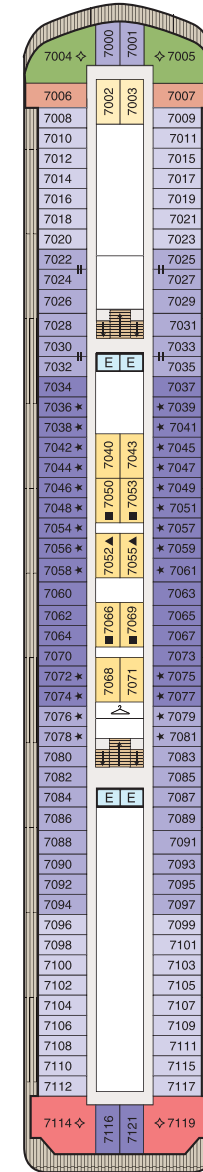

### DECK 7

- Laundryette
- Staterooms

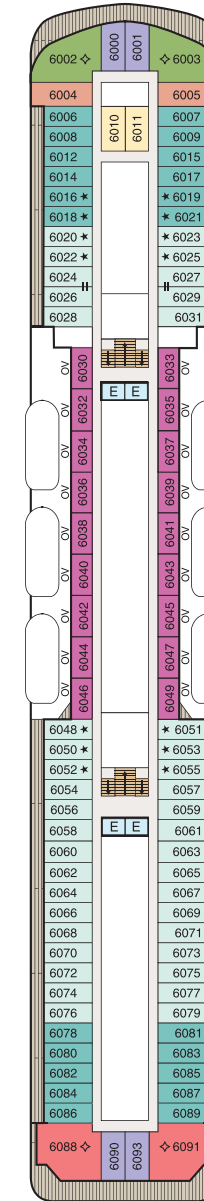

### DECK 6

- Staterooms

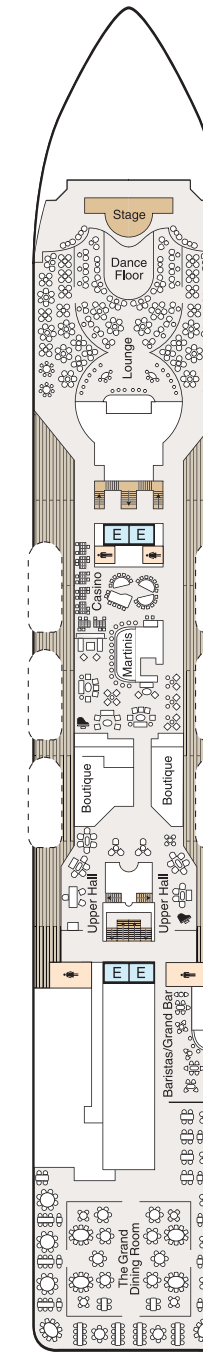

### DECK 5

- Show Lounge
- Boutiques
- Upper Hall
- Oceania Club Ambassador Desk
- Martinis
- Casino
- Baristas
- The Grand Bar
- The Grand Dining Room

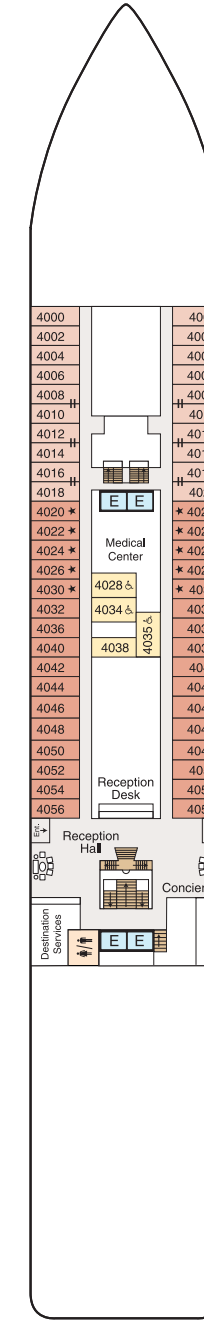

### DECK 4

- Reception Desk
- Reception Hall
- Destination Services
- Concierge
- Medical Center
- Staterooms

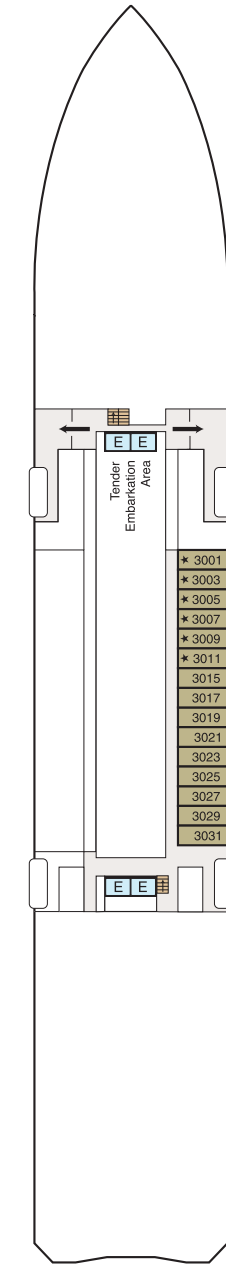

### DECK 3

- Staterooms