

SYMBOL LEGEND

- Restrooms

Elevator

Launderette

Obstructed Views
- Quad with Pullman

Quad with Sofabed

Connecting Staterooms

Wheelchair Accessible
- Triple with Pullman

Triple with Sofabed

3rd guest occupancy available upon request

SHIPS' SPECIFICATIONS

Year Built: *Insignia* 1998 | Re-Inspiration Dates: *Insignia* 2018

Gross Tonnage: 30,277 | Length: 593.7 feet | Beam: 83.5 feet | Cruising Speed: 18 knots | Guest Decks: 9

Guest Capacity (Double Occupancy): 656 | Staff Size: 400 | Guest-to-Staff Ratio: 1.64 to 1

Nationality of Officers: European | Country of Registry: Marshall Islands

STATEROOM COLOR LEGEND

OS	VS	PH1	PH2	PH3	A1	A2	A3
B1	B2	C1	C2	D	S	F	G

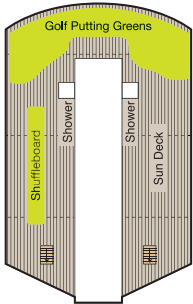

- DECK 11
- Golf Putting Greens
 - Shuffleboard
 - Sun Deck



- DECK 10
- Toscana
 - Polo Grill
 - Library
 - Fitness Track
 - Horizons
 - Artist Loft, available on World Cruises

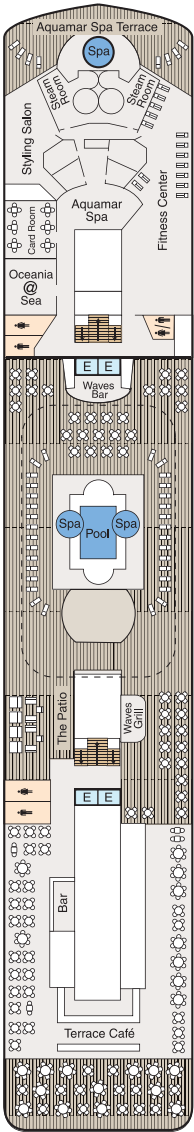

- DECK 9
- Terrace Café
 - Waves Grill
 - Waves Bar
 - Pool Deck
 - Oceania@Sea
 - Aquamar Spa + Vitality Center
 - Aquamar Spa Terrace
 - Fitness Center
 - Salon

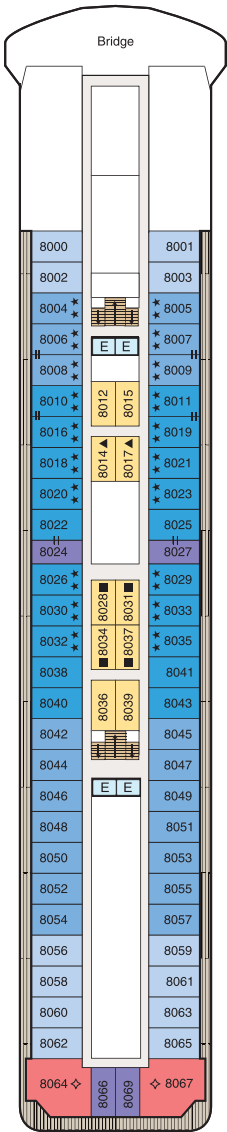

- DECK 8
- Bridge
 - Staterooms

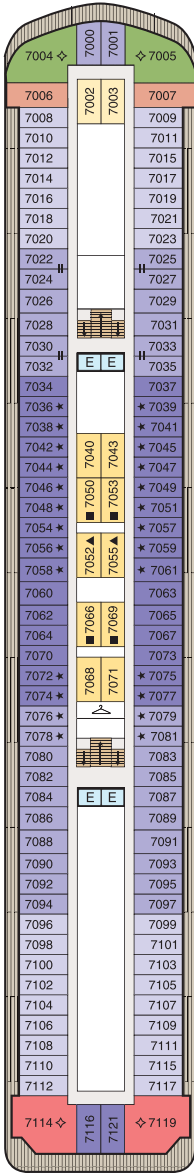

- DECK 7
- Launderette
 - Staterooms

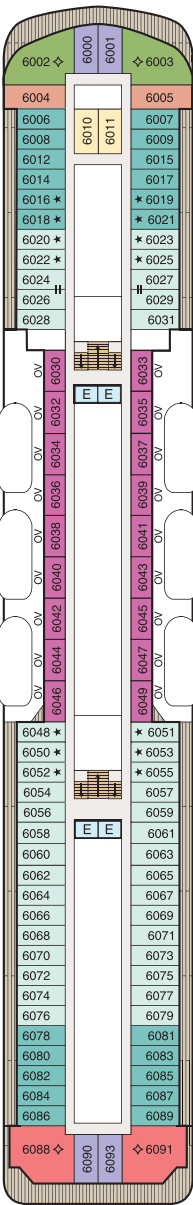

- DECK 6
- Staterooms

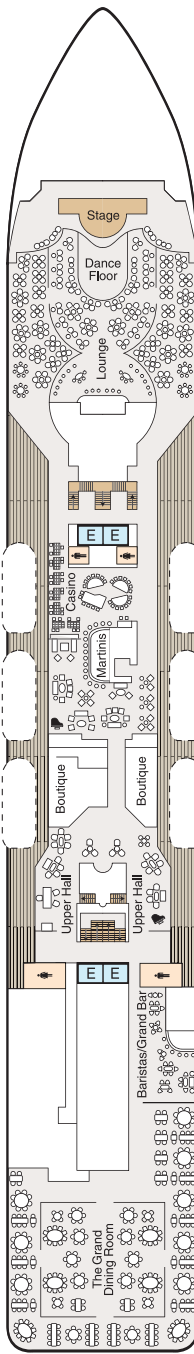

- DECK 5
- Show Lounge
 - Boutiques
 - Upper Hall
 - Oceania Club Ambassador Desk
 - Martinis
 - Casino
 - Baristas
 - The Grand Bar
 - The Grand Dining Room

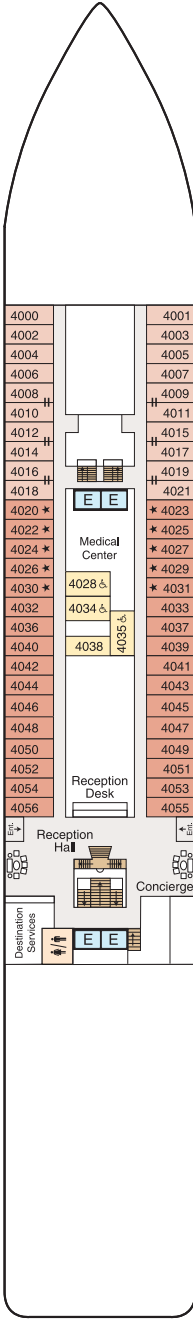

- DECK 4
- Reception Desk
 - Reception Hall
 - Destination Services
 - Concierge
 - Medical Center
 - Staterooms

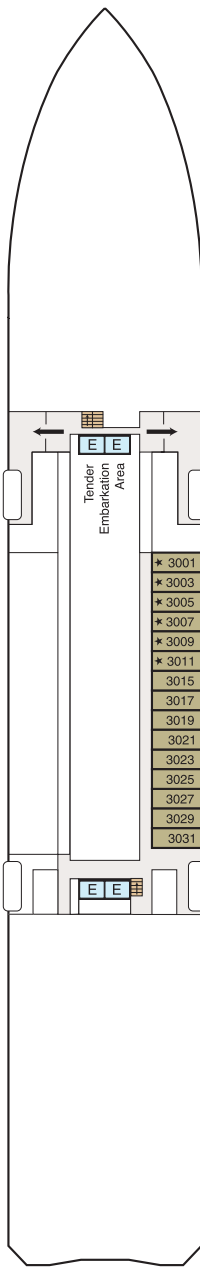

- DECK 3
- Staterooms